



**SARASOTA**  
County Schools

**Office of the Assistant Superintendent**  
**Chief Operations Officer**  
1960 Landings Blvd., Sarasota, FL 34231  
941-927-9000, ext. 31103 • fax 941-927-2539  
[SarasotaCountySchools.net](http://SarasotaCountySchools.net)

---

**To: Board Members**  
**Superintendent**

**From: Assistant Superintendent/Chief Operating Officer**

**Date: June 6, 2018**

**Subject: Read- Ahead, June 19, 2018 Work Session, Inset Attendance Zones**

**Board Members,**

As you know, we have some time on your June 19, 2018 Work Session agenda to discuss Inset Attendance Zones, specifically the elementary attendance zones that serve north Sarasota. Several of you have asked questions about these attendance zones from a number of perspectives. This work session is intended to give you an opportunity to publicly discuss these zones

From a staff perspective we're hoping that this work session is the first of several conversations regarding this topic. Rather than ask staff to spend a lot of energy producing data that may or may not be helpful, we see this first meeting as a dialog to learn more about your concerns and to get direction. Once we better understand what you may be trying to accomplish we can produce and provide more information.

Having said that, to get the conversation started we are providing two categorical pieces of information. First, at Tab 1 is information regarding school capacity, enrollment, inset zone populations, and where the students in the inset zones are actually attending school. The first page of the Tab is a map showing the attendance zones. The second page is a summary of the attendance patterns for each school with an inset area. The remainder of Tab 1 is a by-school snapshot of capacity, enrollment, and inset zone attendance patterns. For each school we've included a summary of where the students who live in each inset area attend school (if other than their districted inset) and a map indicating the students living in the inset, by the school they are actually attending. Please note that an individual dot may represent more than one student.

Tab 2 is intended to give you some general visibility into the Transportation component of the discussion. The first page of this Tab includes a summary of all of the inset zone routes. Routes are sorted by school and show the size of the load, length of the route, and number of stops. As you review this data understand two nuances. First, load size represents the number of "eligible riders," not necessarily the number of students who actually get on the bus. Second, route length is based on an electronic estimate of route time. Things like traffic and even season can impact the actual route length. The remainder of Tab 2 are the actual route sheets for each of the summarized routes. We've also included a somewhat crude map of each route, indicating stop locations.

Finally, at Tab 3 are three court documents we hope put the conversation into a historic context. The first document is an order from the Federal Court stating that the District achieved unitary status. The remaining two documents are the Motion to Dismiss filed by the Defendant (the Board) and the Position of the Plaintiff. Note that the Position of the Plaintiff includes a statement that reads, in part, "Defendant Board has met its constitutional duty to disestablish its former dual system in a prompt, honorable and responsible fashion that might well serve as a model for other Boards seeking to comply with federal court mandates."

Should you have any questions or comments please feel free to call me at 927-9000, ext. 31103 any time and I'd be happy to discuss them with you. We look forward to the Work Session.

**TAB**

**1**

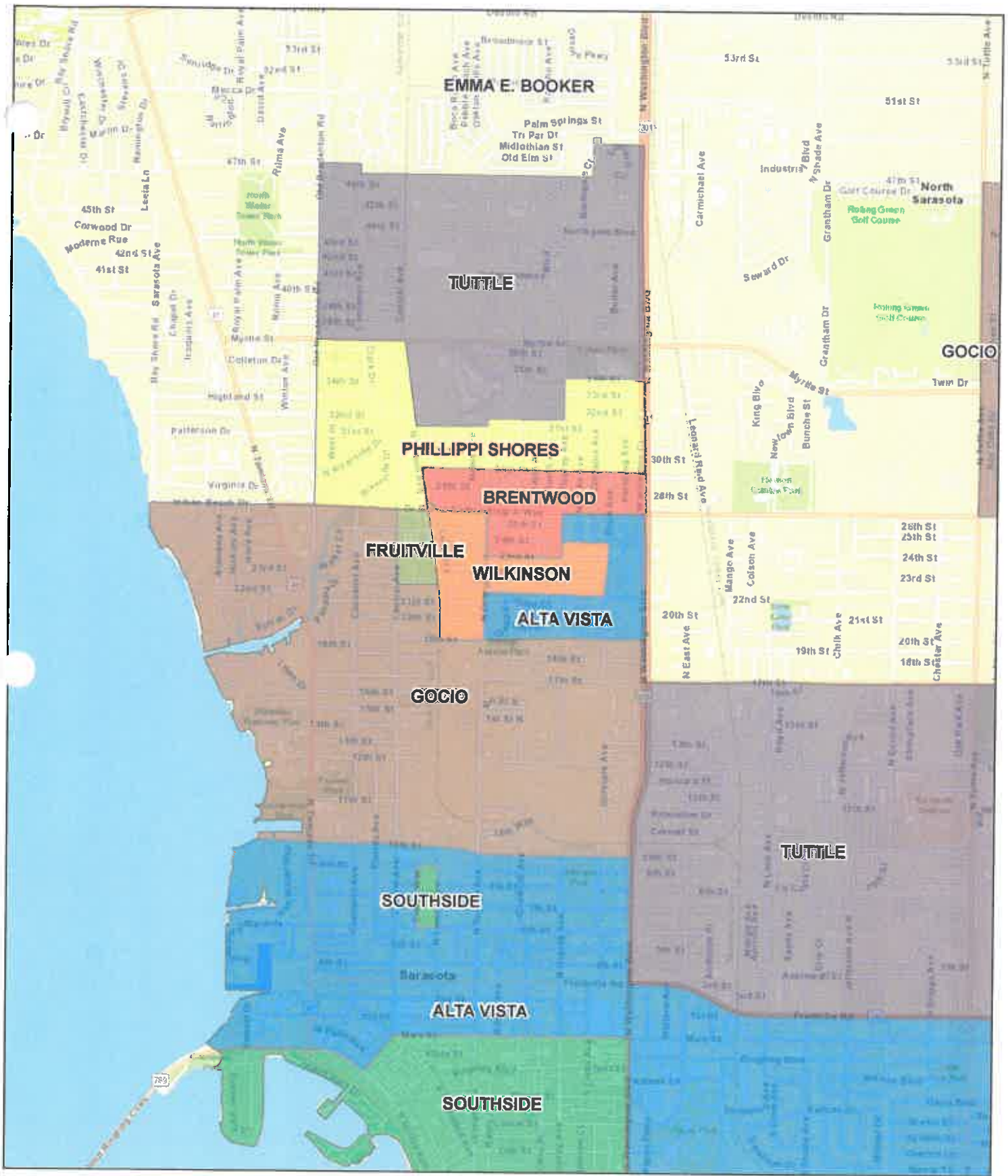

Elementary Inset Attendance Zones

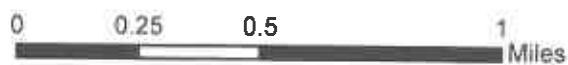

## 2017/18 North County Inset Data

| School  | Permanent FISH |  | Portable FISH |                   | Total FISH Capacity | May 2018 Enrollment Counts | Total Students Living In Inset Zone |               | Inset Students Attending |     | Percent of Inset Students Attending Zoned School |
|---|----------------|--|---------------|-------------------|---------------------|----------------------------|-------------------------------------|---------------|--------------------------|-----|--|
|   | Capacity       |  | Capacity      |                   |                     |                            | Inset Zone                          | Inset Schools | Other Schools            |     |  |
| Alta Vista  | 848            |  | 0             |                   | 848                 | 589                        | 174                                 | 130           | 44                       | 75% |  |
| Brentwood   | 1043           |  | 0             |                   | 1043                | 680                        | 93                                  | 51            | 42                       | 55% |  |
| Fruitville  | 985            |  | 0             |                   | 985                 | 736                        | 57                                  | 32            | 25                       | 56% |  |
| Gocio   | 584            |  | 347           |                   | 931                 | 644                        | 210                                 | 140           | 40                       | 67% |  |
| Phillippi Shores                                      | 731            |  | 0             |                   | 731                 | 785                        | 179                                 | 85            | 94                       | 48% |  |
| Southside   | 826            |  | 47            |                   | 873                 | 769                        | 2                                   | 1             | 1                        | 50% |  |
| Tuttle  | 613            |  | 354           |                   | 967                 | 732                        | 92                                  | 58            | 34                       | 63% |  |
| Wilkinson   | 786            |  | 0             |                   | 786                 | 485                        | 114                                 | 66            | 48                       | 58% |  |
| Emma E Booker   | 746            |  | 231           |                   | 977                 | 565                        |                                     |               |                          |     |  |
| Bay Haven   | 664            |  | 0             |                   | 664                 | 603                        |                                     |               |                          |     |  |
| <b>Students attending Bay Haven from these zones:</b> |                |  |               |                   |                     |                            |                                     |               |                          |     |  |
| Alta Vista Zone                                       | 52             |  |               | Laurel Nokomis    | 4                   |                            |                                     |               |                          |     |  |
| Ashton Zone   | 9              |  |               | Phillippi Zone    | 20                  |                            |                                     |               |                          |     |  |
| Brentwood Zone  | 36             |  |               | Southside Zone    | 8                   |                            |                                     |               |                          |     |  |
| Emma E Booker Zn                                      | 157            |  |               | Tatum Ridge Zone  | 10                  |                            |                                     |               |                          |     |  |
| Fruitville Zone                                       | 17             |  |               | Taylor Ranch Zone | 1                   |                            |                                     |               |                          |     |  |
| Gocio Zone  | 71             |  |               | Tuttle Zone       | 63                  |                            |                                     |               |                          |     |  |
| Gulf Gate Zone  | 4              |  |               | Wilkinson Zone    | 28                  |                            |                                     |               |                          |     |  |
| Lakeview Zone   | 9              |  |               | Out of County     | 111                 |                            |                                     |               |                          |     |  |
| Lamarque Zone   | 2              |  |               |                   |                     |                            |                                     |               |                          |     |  |

## Alta Vista Elementary Inset Analysis

| School     | Permanent FISH Capacity |   | Portable FISH Capacity |   | May 2018 Enrollment Counts |     | Total Students Living in Inset Zone |     | Inset Students Attending Zoned School |     | % Inset Students Attending Inset School |  | Inset Students Attending Other Schools |  |
|------------|-------------------------|---|------------------------|---|----------------------------|-----|-------------------------------------|-----|---------------------------------------|-----|---|--|--|--|
|            | 848                     | 0 | 848                    | 0 | 589                        | 174 | 130                                 | 75% | 44                                    | 25% |   |  |  |  |
| Alta Vista |                         |   |                        |   |                            |     |                                     |     |                                       |     |   |  |  |  |

**\*\*List of Inset Students Attending Other Schools-**

| School      | Attending | Student Total | % of Total Inset Students |
|-------------|-----------|---------------|---------------------------|
| Bay Haven   | 6         | 3%            |                           |
| Brentwood   | 1         | <1%           |                           |
| EE Booker   | 15        | 8%            |                           |
| Fruitville  | 2         | 1%            |                           |
| Gocio       | 7         | 4%            |                           |
| Oak Park    | 3         | 1%            |                           |
| Southside   | 2         | 1%            |                           |
| Tatum Ridge | 1         | <1%           |                           |
| Tuttle      | 3         | 1%            |                           |
| Wilkinson   | 4         | 2%            |                           |

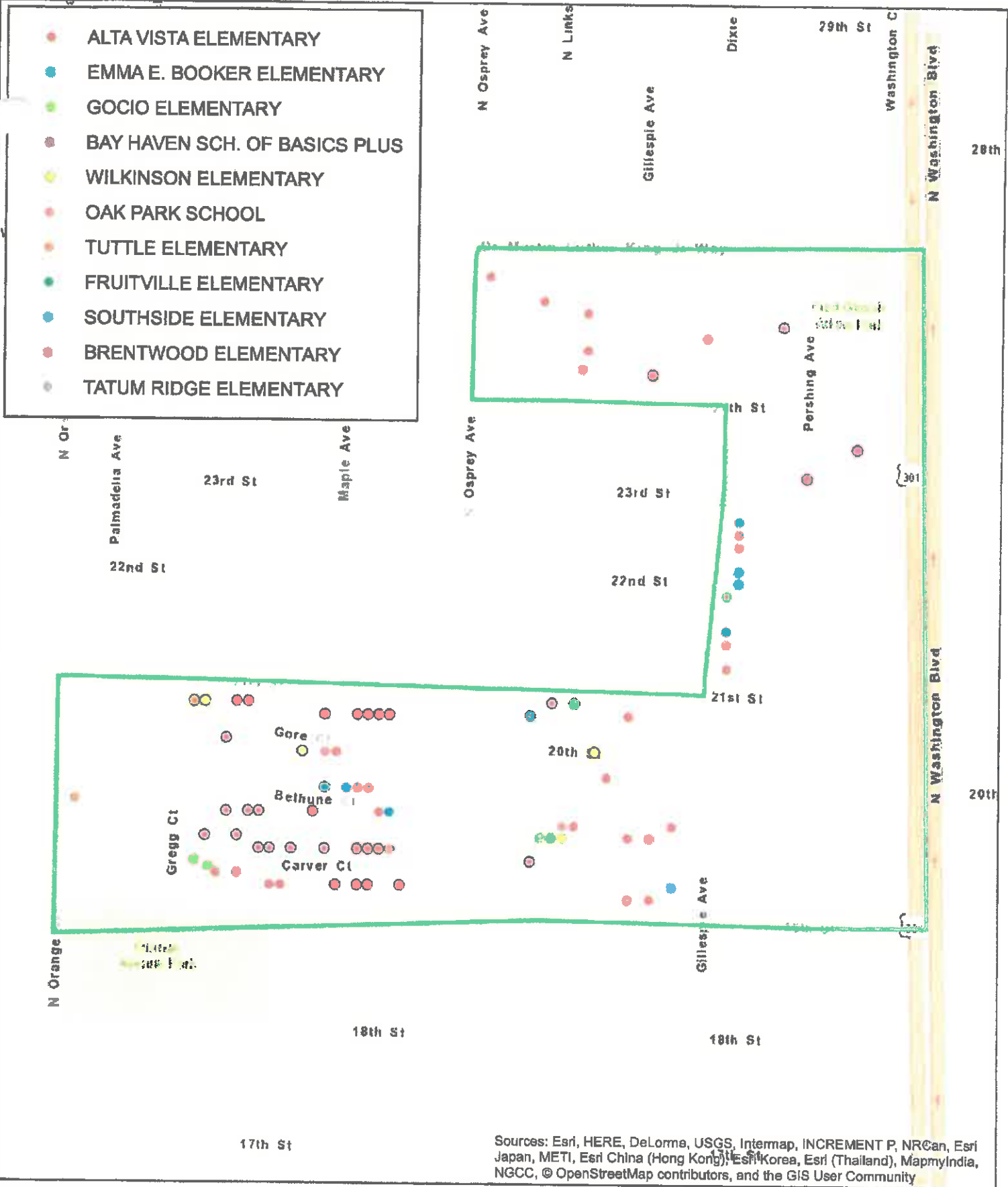

**Alta Vista Inset:  
Elementary Students Living in Alta Vista inset area**







- BRENTWOOD ELEMENTARY
- EMMA E. BOOKER ELEMENTARY
- BAY HAVEN SCH. OF BASICS PLUS
- GOCIO ELEMENTARY
- ALTA VISTA ELEMENTARY
- OAK PARK SCHOOL
- TUTTLE ELEMENTARY
- FRUITVILLE ELEMENTARY
- WILKINSON ELEMENTARY
- IMAGINE SCHOOL AT PALMER RANCH
- TATUM RIDGE ELEMENTARY

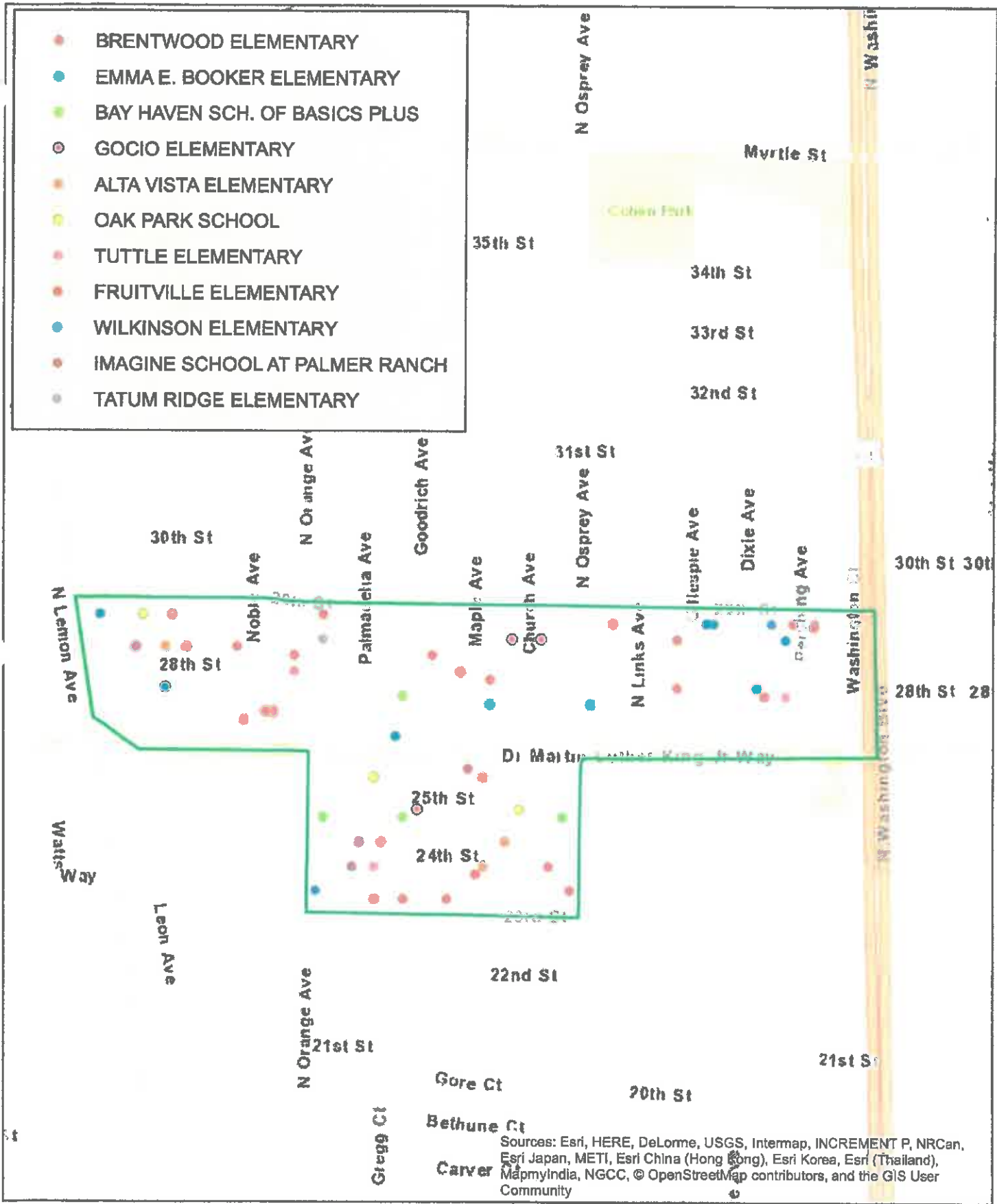

Brentwood Inset:  
Elementary Students Living in Brentwood Inset Area



Sources: Esri, HERE, DeLorme, USGS, Intermap, INCREMENT P, NRCan, Esri Japan, METI, Esri China (Hong Kong), Esri Korea, Esri (Thailand), MapmyIndia, NGCC, © OpenStreetMap contributors, and the GIS User Community

## Fruitville Elementary Inset Analysis

| School  | Permanent FISH Capacity |     | Portable FISH Capacity |   | May 2018 Enrollment Counts | Total Students Living In Inset Zone |    | Inset Students Attending Zoned School |    | Inset Students Attending Other Schools** |     | Percent of Inset Students Attending Other Schools |
|---|-------------------------|-----|------------------------|---|----------------------------|-------------------------------------|----|---------------------------------------|----|--|-----|---|
|   | 985                     | 0   | 985                    | 0 |                            | 57                                  | 32 | 32                                    | 25 | 56%                                      | 44% |   |
| Fruitville  | 985                     | 0   | 985                    | 0 | 736                        | 57                                  | 32 | 32                                    | 25 | 56%                                      | 44% |   |
| **List of Inset Students Attending Other Schools- |                         |     |                        |   |                            |                                     |    |                                       |    |  |     |   |
|   | <u>Student Total</u>    |     | <u>Inset Students</u>  |   | <u>% of Total</u>          |                                     |    |                                       |    |  |     |   |
| <u>School Attending</u>                           |                         |     |                        |   |                            |                                     |    |                                       |    |  |     |   |
| Alta Vista  | 5                       | 8%  |                        |   |                            |                                     |    |                                       |    |  |     |   |
| Bay Haven   | 4                       | 7%  |                        |   |                            |                                     |    |                                       |    |  |     |   |
| Emma Booker                                       | 8                       | 14% |                        |   |                            |                                     |    |                                       |    |  |     |   |
| Gulf Gate   | 1                       | <1% |                        |   |                            |                                     |    |                                       |    |  |     |   |
| Lakeview  | 1                       | <1% |                        |   |                            |                                     |    |                                       |    |  |     |   |
| Southside   | 2                       | 3%  |                        |   |                            |                                     |    |                                       |    |  |     |   |
| Tatum Ridge                                       | 1                       | <1% |                        |   |                            |                                     |    |                                       |    |  |     |   |
| Tuttle  | 2                       | 3%  |                        |   |                            |                                     |    |                                       |    |  |     |   |
| Wilkinson   | 1                       | <1% |                        |   |                            |                                     |    |                                       |    |  |     |   |

- FRUITVILLE ELEMENTARY
- EMMA E. BOOKER ELEMENTARY
- ALTA VISTA ELEMENTARY
- BAY HAVEN SCH. OF BASICS PLUS
- SOUTHSIDE ELEMENTARY
- TUTTLE ELEMENTARY
- GULF GATE ELEMENTARY
- LAKEVIEW ELEMENTARY
- TATUM RIDGE ELEMENTARY
- WILKINSON ELEMENTARY



Sources: Esri, HERE, DeLorme, USGS, Intermap, INCREMENT P, NRCan, Esri Japan, METI, Esri China (Hong Kong), Esri Korea, Esri (Thailand), MapmyIndia, NGCC, © OpenStreetMap contributors, and the GIS User Community

Fruitville Inset:  
Elementary Students Living in Fruitville Inset Area



## Gocio Elementary Inset Analysis

| School | Permanent     |     | Portable      |     | May 2018 Enrollment Counts | Total Students      |     | Inset Students       |     | Percent of Inset Students |     | Inset Students         |     | Percent of Inset Students |    |                         |     |
|--------|---------------|-----|---------------|-----|----------------------------|---------------------|-----|----------------------|-----|---------------------------|-----|------------------------|-----|---------------------------|----|-------------------------|-----|
|        | FISH Capacity | 584 | FISH Capacity | 347 |                            | Total FISH Capacity | 931 | Living In Inset Zone | 210 | Attending Zoned School    | 140 | Attending Zoned School | 67% | Attending Other Schools** | 70 | Attending Other Schools | 33% |
| Gocio  |               |     |               |     | 644                        |                     |     |                      |     |                           |     |                        |     |                           |    |                         |     |

**\*\*List of Inset Students Attending Other Schools-**

| School Attending | Student Total | % of Total     |          |
|------------------|---------------|----------------|----------|
|                  |               | Inset Students | Students |
| Alta Vista       | 13            | 6%             |          |
| Bay Haven        | 26            | 12%            |          |
| Brentwood        | 3             | 1%             |          |
| Emma Booker      | 10            | 5%             |          |
| Fruitville       | 2             | <1%            |          |
| Home Schooled    | 1             | <1%            |          |
| Island VII Mont. | 1             | <1%            |          |
| Oak Park         | 1             | <1%            |          |
| Pine View        | 2             | <1%            |          |
| Southside        | 1             | <1%            |          |
| Turtle           | 7             | 3%             |          |
| Wilkinson        | 1             | <1%            |          |

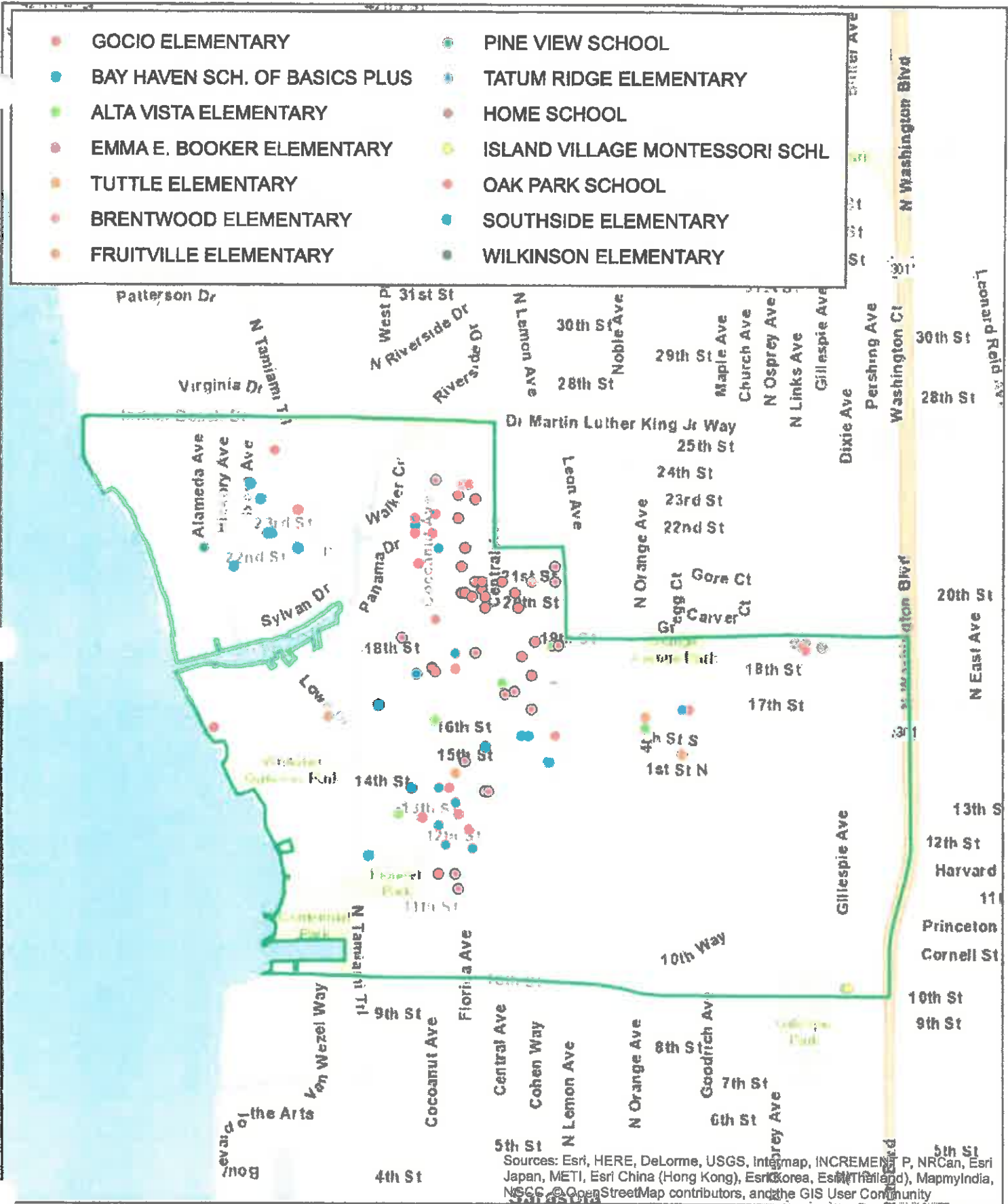

Sources: Esri, HERE, DeLorme, USGS, Intermap, INCREMENT P, NRCan, Esri Japan, METI, Esri China (Hong Kong), Esri Korea, Esri Thailand, MapmyIndia, NCCG, OpenStreetMap contributors, and the GIS User Community

Gocio Inset:  
Elementary Students Living in the Gocio Inset Area



## Phillippi Shores Elementary Inset Analysis

| School           | Permanent FISH Capacity |   | Portable FISH Capacity |   | May 2018 Enrollment Counts | Total Students Living In Inset Zone |     | Inset Students Attending Zoned School |     | Percent of Inset Students Attending Zoned School |     | Inset Students Attending Other Schools** |  | Percent of Inset Students Attending Other Schools |
|------------------|-------------------------|---|------------------------|---|----------------------------|-------------------------------------|-----|---------------------------------------|-----|--|-----|--|--|---|
|                  | 731                     | 0 | 731                    | 0 |                            | 785                                 | 179 | 85                                    | 48% | 94   | 52% |  |  |   |
| Phillippi Shores | 731                     | 0 | 731                    | 0 | 785                        | 179                                 | 85  | 48%                                   | 94  | 52%  |     |  |  |   |

**\*\*List of Inset Students Attending Other Schools-**

| School Attending  | Student Total | % of Total     |         |
|-------------------|---------------|----------------|---------|
|                   |               | Inset Students | Percent |
| Alta Vista        | 3             | 1.50%          |         |
| Bay Haven         | 15            | 8%             |         |
| Brentwood         | 11            | 6%             |         |
| Emma Booker       | 28            | 16%            |         |
| Fruitville        | 11            | 6%             |         |
| Gocio             | 5             | 2%             |         |
| Gulf Gate         | 1             | <1%            |         |
| John McKay Schol. | 1             | <1%            |         |
| Oak Park          | 3             | 1.50%          |         |
| Sara Acad of Arts | 2             | 1%             |         |
| Tatum Ridge       | 1             | >1%            |         |
| Tuttle            | 1             | <1%            |         |
| Wilkinson         | 3             | 1.50%          |         |



## Southside Elementary Inset Analysis

| School   | Permanent FISH Capacity |    | Total FISH Capacity | May 2018 Enrollment Counts | Total Students Living In Inset Zone |     | Inset Students Attending Zoned School |   | Inset Students Attending Other Schools** |     | Percent of Inset Students Attending Other Schools |
|--|-------------------------|----|---------------------|----------------------------|-------------------------------------|-----|---------------------------------------|---|--|-----|---|
|  | 826                     | 47 |                     |                            | 873                                 | 769 | 2                                     | 1 | 1  | 50% |   |
| Southside  |                         |    |                     |                            |                                     |     |                                       |   |  |     | 50%   |
| <b>**List of Inset Students Attending Other Schools-</b> |                         |    |                     |                            |                                     |     |                                       |   |  |     |   |
| <b>% of Total Inset Students</b>                         |                         |    |                     |                            |                                     |     |                                       |   |  |     |   |
| <u>School Attending</u>                                  | <u>Student Total</u>    |    |                     |                            |                                     |     |                                       |   |  |     |   |
| Southside  | 1                       |    |                     |                            |                                     |     |                                       |   |  |     |   |
| Pine View  | 1                       |    |                     |                            |                                     |     |                                       |   |  |     |   |



● PINE VIEW SCHOOL  
● SOUTHSIDE ELEMENTARY

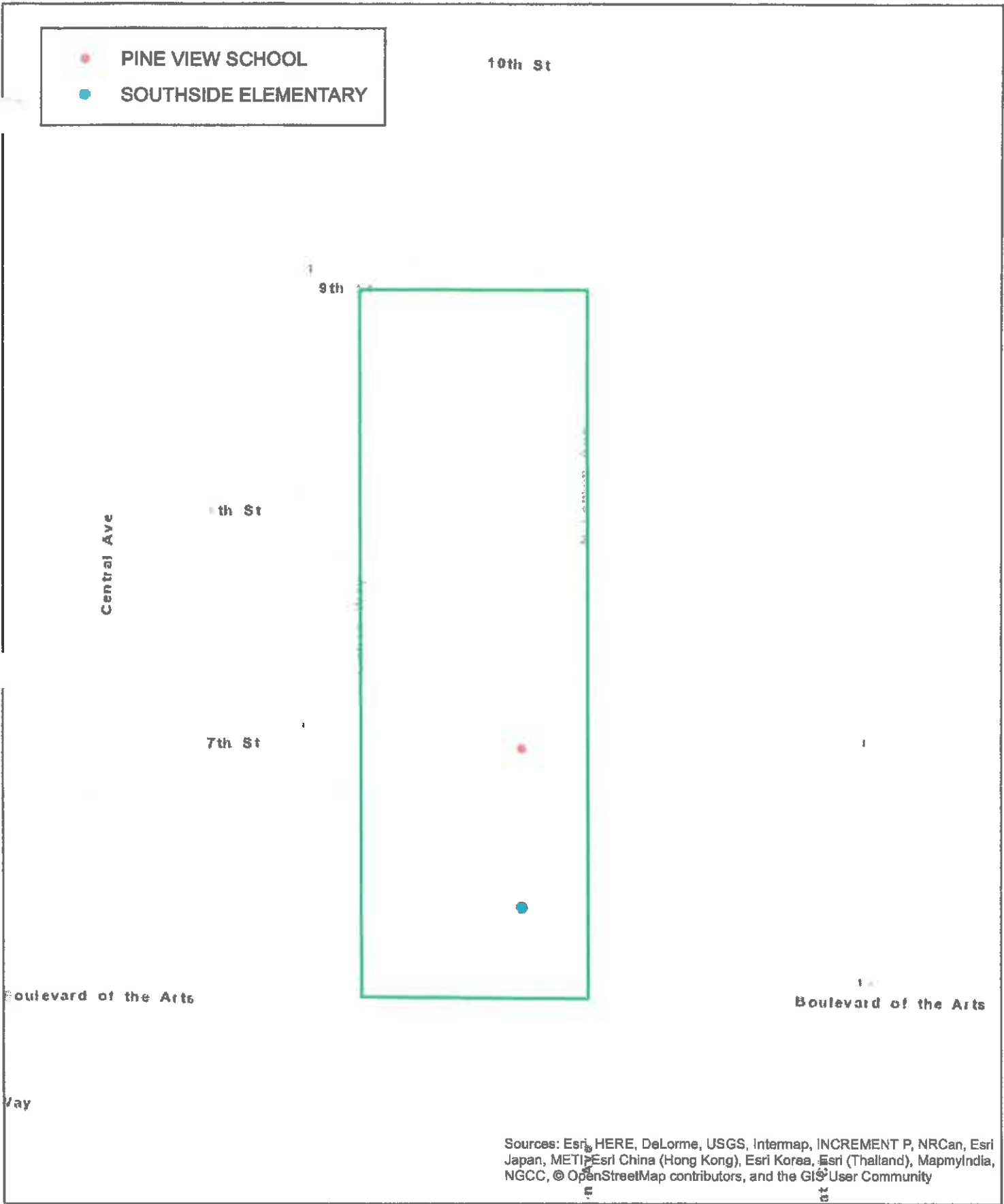

Sources: Esri, HERE, DeLorme, USGS, Intermap, INCREMENT P, NRCan, Esri Japan, METI, Esri China (Hong Kong), Esri Korea, Esri (Thailand), MapmyIndia, NGCC, © OpenStreetMap contributors, and the GIS User Community

Southside Inset:  
Elementary Students Living in the Southside Inset Area



## Tuttle Elementary Inset Analysis

| School   | Permanent FISH Capacity |                           | Portable FISH Capacity |     | Total FISH Capacity | May 2018 Enrollment Counts | Total Students |     | Inset Students |    | Percent of Inset Students |    | Inset Students         |     | Percent of Inset Students Attending Other Schools |                           |               |                           |  |               |          |            |   |    |  |           |    |     |  |           |   |    |  |             |   |    |  |       |   |     |  |           |   |    |  |               |   |    |  |           |   |    |  |
|--|-------------------------|---------------------------|------------------------|-----|---------------------|----------------------------|----------------|-----|----------------|----|---------------------------|----|------------------------|-----|---|---------------------------|---------------|---------------------------|--|---------------|----------|------------|---|----|--|-----------|----|-----|--|-----------|---|----|--|-------------|---|----|--|-------|---|-----|--|-----------|---|----|--|---------------|---|----|--|-----------|---|----|--|
|  | FISH Capacity           | 613                       | FISH Capacity          | 354 |                     |                            | 967            | 732 | Living In Zone | 92 | Attending Zoned School    | 58 | Attending Zoned School | 63% |   | Attending Other Schools** | 34            |                           |  |               |          |            |   |    |  |           |    |     |  |           |   |    |  |             |   |    |  |       |   |     |  |           |   |    |  |               |   |    |  |           |   |    |  |
| Tuttle   |                         |                           |                        |     |                     |                            |                |     |                |    |                           |    |                        |     | 37%   |                           |               |                           |  |               |          |            |   |    |  |           |    |     |  |           |   |    |  |             |   |    |  |       |   |     |  |           |   |    |  |               |   |    |  |           |   |    |  |
| <p><b>**List of Inset Students Attending Other Schools-</b></p> <table border="1"> <thead> <tr> <th rowspan="2">School Attending</th> <th rowspan="2">Student Total</th> <th colspan="2">% of Total Inset Students</th> </tr> <tr> <th>Student Total</th> <th>Students</th> </tr> </thead> <tbody> <tr> <td>Alta Vista</td> <td>2</td> <td>2%</td> <td></td> </tr> <tr> <td>Bay Haven</td> <td>12</td> <td>13%</td> <td></td> </tr> <tr> <td>Brentwood</td> <td>1</td> <td>1%</td> <td></td> </tr> <tr> <td>Emma Booker</td> <td>5</td> <td>5%</td> <td></td> </tr> <tr> <td>Gocio</td> <td>9</td> <td>10%</td> <td></td> </tr> <tr> <td>Gulf Gate</td> <td>2</td> <td>2%</td> <td></td> </tr> <tr> <td>Home Schooled</td> <td>1</td> <td>1%</td> <td></td> </tr> <tr> <td>Wilkinson</td> <td>2</td> <td>2%</td> <td></td> </tr> </tbody> </table> |                         |                           |                        |     |                     |                            |                |     |                |    |                           |    |                        |     |   | School Attending          | Student Total | % of Total Inset Students |  | Student Total | Students | Alta Vista | 2 | 2% |  | Bay Haven | 12 | 13% |  | Brentwood | 1 | 1% |  | Emma Booker | 5 | 5% |  | Gocio | 9 | 10% |  | Gulf Gate | 2 | 2% |  | Home Schooled | 1 | 1% |  | Wilkinson | 2 | 2% |  |
| School Attending   | Student Total           | % of Total Inset Students |                        |     |                     |                            |                |     |                |    |                           |    |                        |     |   |                           |               |                           |  |               |          |            |   |    |  |           |    |     |  |           |   |    |  |             |   |    |  |       |   |     |  |           |   |    |  |               |   |    |  |           |   |    |  |
|  |                         | Student Total             | Students               |     |                     |                            |                |     |                |    |                           |    |                        |     |   |                           |               |                           |  |               |          |            |   |    |  |           |    |     |  |           |   |    |  |             |   |    |  |       |   |     |  |           |   |    |  |               |   |    |  |           |   |    |  |
| Alta Vista   | 2                       | 2%                        |                        |     |                     |                            |                |     |                |    |                           |    |                        |     |   |                           |               |                           |  |               |          |            |   |    |  |           |    |     |  |           |   |    |  |             |   |    |  |       |   |     |  |           |   |    |  |               |   |    |  |           |   |    |  |
| Bay Haven  | 12                      | 13%                       |                        |     |                     |                            |                |     |                |    |                           |    |                        |     |   |                           |               |                           |  |               |          |            |   |    |  |           |    |     |  |           |   |    |  |             |   |    |  |       |   |     |  |           |   |    |  |               |   |    |  |           |   |    |  |
| Brentwood  | 1                       | 1%                        |                        |     |                     |                            |                |     |                |    |                           |    |                        |     |   |                           |               |                           |  |               |          |            |   |    |  |           |    |     |  |           |   |    |  |             |   |    |  |       |   |     |  |           |   |    |  |               |   |    |  |           |   |    |  |
| Emma Booker  | 5                       | 5%                        |                        |     |                     |                            |                |     |                |    |                           |    |                        |     |   |                           |               |                           |  |               |          |            |   |    |  |           |    |     |  |           |   |    |  |             |   |    |  |       |   |     |  |           |   |    |  |               |   |    |  |           |   |    |  |
| Gocio  | 9                       | 10%                       |                        |     |                     |                            |                |     |                |    |                           |    |                        |     |   |                           |               |                           |  |               |          |            |   |    |  |           |    |     |  |           |   |    |  |             |   |    |  |       |   |     |  |           |   |    |  |               |   |    |  |           |   |    |  |
| Gulf Gate  | 2                       | 2%                        |                        |     |                     |                            |                |     |                |    |                           |    |                        |     |   |                           |               |                           |  |               |          |            |   |    |  |           |    |     |  |           |   |    |  |             |   |    |  |       |   |     |  |           |   |    |  |               |   |    |  |           |   |    |  |
| Home Schooled  | 1                       | 1%                        |                        |     |                     |                            |                |     |                |    |                           |    |                        |     |   |                           |               |                           |  |               |          |            |   |    |  |           |    |     |  |           |   |    |  |             |   |    |  |       |   |     |  |           |   |    |  |               |   |    |  |           |   |    |  |
| Wilkinson  | 2                       | 2%                        |                        |     |                     |                            |                |     |                |    |                           |    |                        |     |   |                           |               |                           |  |               |          |            |   |    |  |           |    |     |  |           |   |    |  |             |   |    |  |       |   |     |  |           |   |    |  |               |   |    |  |           |   |    |  |

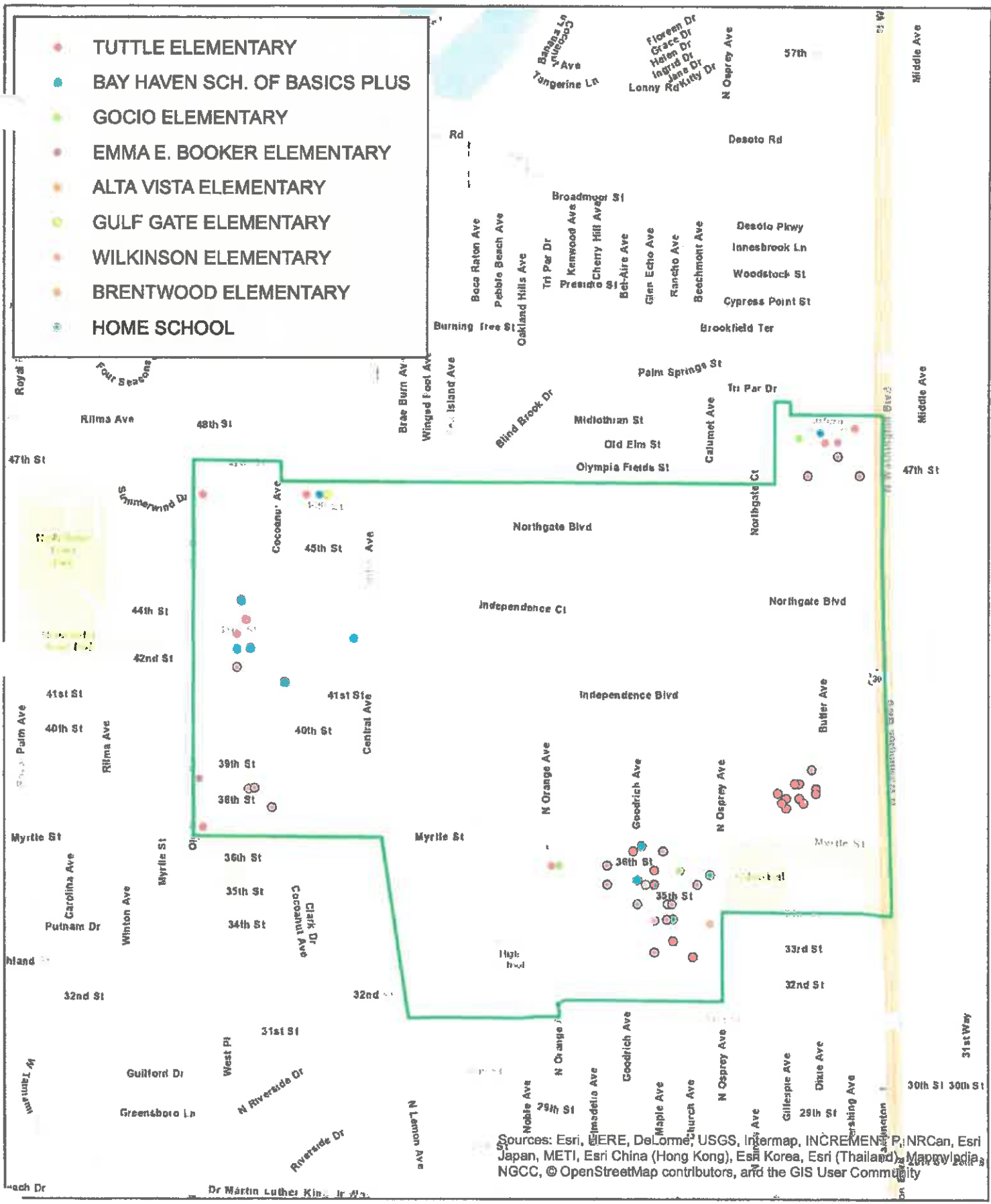

- TUTTLE ELEMENTARY
- BAY HAVEN SCH. OF BASICS PLUS
- GOCIO ELEMENTARY
- EMMA E. BOOKER ELEMENTARY
- ALTA VISTA ELEMENTARY
- GULF GATE ELEMENTARY
- WILKINSON ELEMENTARY
- BRENTWOOD ELEMENTARY
- HOME SCHOOL

Sources: Esri, HERE, DeLorme, USGS, Intermap, INCREMENT P, NRCan, Esri Japan, METI, Esri China (Hong Kong), Esri Korea, Esri (Thailand), Mapbox, Swatch, NGCC, © OpenStreetMap contributors, and the GIS User Community

Tuttle Inset:  
Elementary Students Living in the Tuttle Inset Area





- |   |                               |   |                                |
|---|-------------------------------|---|--------------------------------|
| ● | WILKINSON ELEMENTARY          | ○ | FRUITVILLE ELEMENTARY          |
| ● | ALTA VISTA ELEMENTARY         | ○ | GOCIO ELEMENTARY               |
| ● | EMMA E. BOOKER ELEMENTARY     | ● | IMAGINE SCHOOL AT PALMER RANCH |
| ○ | BAY HAVEN SCH. OF BASICS PLUS | ● | SOUTHSIDE ELEMENTARY           |
| ● | BRENTWOOD ELEMENTARY          | ○ | HOME SCHOOL                    |
| ● | TUTTLE ELEMENTARY             | ○ | OAK PARK SCHOOL                |

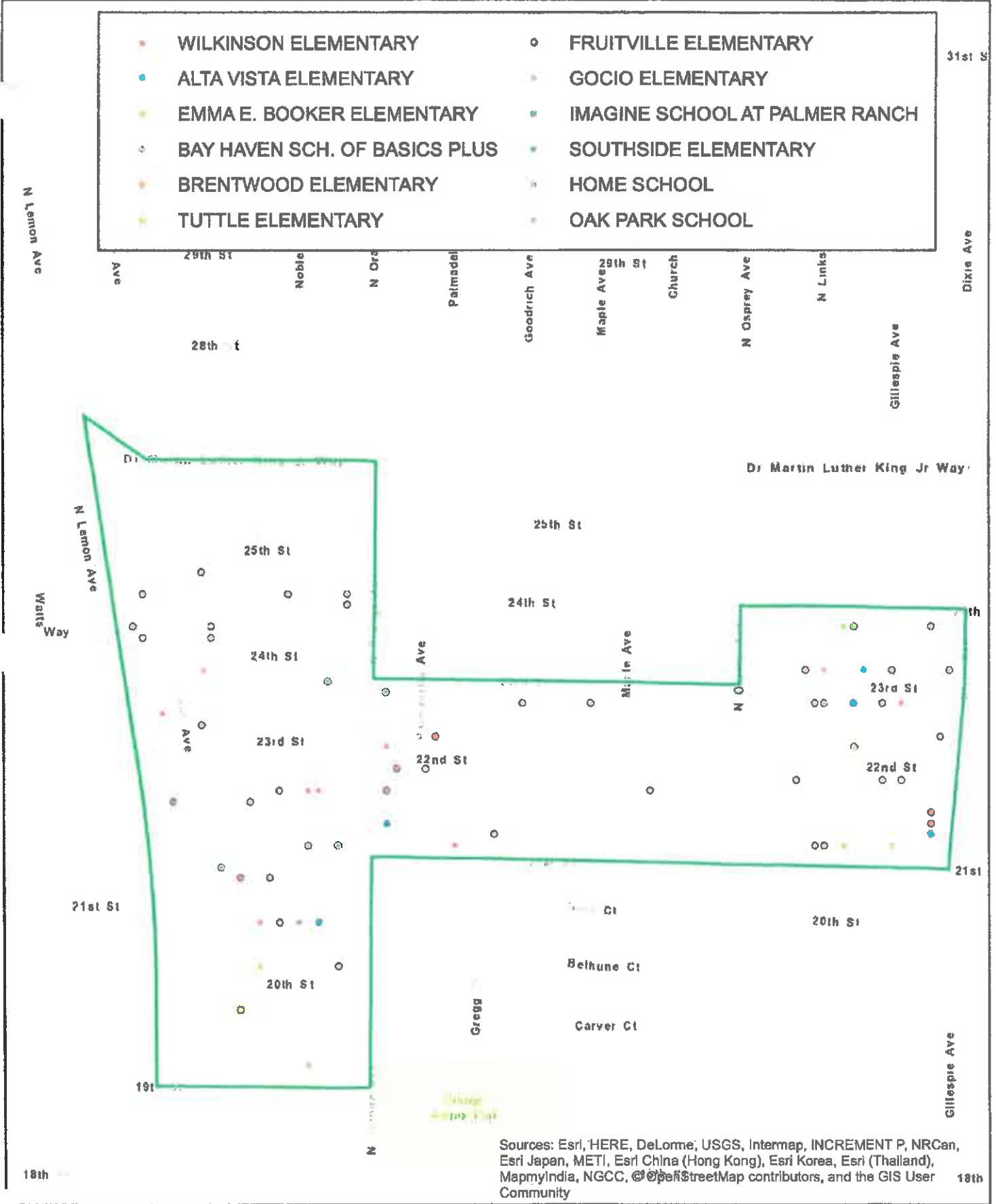

Sources: Esri, HERE, DeLorme, USGS, Intermap, INCREMENT P, NRCan, Esri Japan, METI, Esri China (Hong Kong), Esri Korea, Esri (Thailand), MapmyIndia, NGCC, OpenStreetMap contributors, and the GIS User Community

**Wilkinson Inset:  
Elementary Students Living in the Wilkinson Inset Area**



**TAB**

**2**

| Alta Vista      |         |  | Phillippi Shores |         |  | Brentwood       |         |  | Fruitville      |         |  | Gocio           |         |  |
|-----------------|---------|--|------------------|---------|--|-----------------|---------|--|-----------------|---------|--|-----------------|---------|--|
| <b>Route 1A</b> |         |  | <b>Route 1A</b>  |         |  | <b>Route 1A</b> |         |  | <b>Route 3A</b> |         |  | <b>Route 2A</b> |         |  |
| Load            | 32      |  | Load             | 40      |  | Load            | 45      |  | Load            | 29      |  | Load            | 39      |  |
| Length          | 15 mins |  | Length           | 27 mins |  | Length          | 34 mins |  | Length          | 37 mins |  | Length          | 11 mins |  |
| Stops #         | 1       |  | Stops #          | 3       |  | Stops #         | 3       |  | Stops #         | 1       |  | Stops #         | 2       |  |
| <b>Route 2A</b> |         |  | <b>Route 2A</b>  |         |  | <b>Route 2A</b> |         |  | <b>Route 3A</b> |         |  | <b>Route 3A</b> |         |  |
| Load            | 46      |  | Load             | 40      |  |                 |         |  |                 |         |  | Load            | 39      |  |
| Length          | 47 mins |  | Length           | 32 mins |  |                 |         |  |                 |         |  | Length          | 31 mins |  |
| Stops #         | 4       |  | Stops #          | 3       |  |                 |         |  |                 |         |  | Stops #         | 4       |  |
| <b>Route 3A</b> |         |  | <b>Route 3A</b>  |         |  | <b>Route 3A</b> |         |  | <b>Route 4A</b> |         |  | <b>Route 4A</b> |         |  |
| Load            | 42      |  |                  |         |  |                 |         |  |                 |         |  | Load            | 65      |  |
| Length          | 28 mins |  |                  |         |  |                 |         |  |                 |         |  | Length          | 20 mins |  |
| Stops #         | 4       |  |                  |         |  |                 |         |  |                 |         |  | Stops #         | 2       |  |
| <b>Route 4A</b> |         |  | <b>Route 4A</b>  |         |  | <b>Route 4A</b> |         |  | <b>Route 4A</b> |         |  | <b>Route 4A</b> |         |  |
| Load            | 34      |  |                  |         |  |                 |         |  |                 |         |  |                 |         |  |
| Length          | 25 mins |  |                  |         |  |                 |         |  |                 |         |  |                 |         |  |
| Stops #         | 2       |  |                  |         |  |                 |         |  |                 |         |  |                 |         |  |

| Tuttle          |         |  | Wilkinson       |         |  | Southside       |         |  |
|-----------------|---------|--|-----------------|---------|--|-----------------|---------|--|
| <b>Route 1A</b> |         |  | <b>Route 1A</b> |         |  | <b>Route 1A</b> |         |  |
| Load            | 60      |  | Load            | 36      |  | Load            | 51      |  |
| Length          | 33 mins |  | Length          | 29 mins |  | Length          | 35 mins |  |
| Stops #         | 5       |  | Stops #         | 3       |  | Stops #         | 4       |  |
| <b>Route 2A</b> |         |  | <b>Route 2A</b> |         |  | <b>Route 2A</b> |         |  |
| Load            |         |  | Load            | 26      |  |                 |         |  |
| Length          |         |  | Length          | 23 mins |  |                 |         |  |
| Stops #         |         |  | Stops #         | 2       |  |                 |         |  |

Date Printed: 4/3/2018  
Time Printed: 8:13:01AM

**Vehicle Schedule 2017-2018**  
**Summary Report Bus: 1326**  
ALTA VISTA

Name: 1326 RT 1-A012/17TH  
Driver: DAWN SNYDER  
Attendent:

School(s)  
ALTA VISTA

| Est Time | Stop Description                              | Notes | Load | Dist |
|----------|---|-------|------|------|
| 07:45AM  | 21ST ST & MAPLE AVE/3RD,4TH, & 5TH GRADE ONLY |       | 32   | 2.8  |
| 08:00AM  | ALTA VISTA ELEMENTARY, 6 ALTA VISTA BUS LOOP  |       | 32   | 3.4  |



Date Printed: 4/3/2018  
Time Printed: 9:12:07AM

**Vehicle Schedule 2017-2018**  
**Summary Report Bus: 1327**  
ALTA VISTA

Name: 1327 RT 2-A012/17TH  
Driver: MARY BLOCKER  
Attendant:

School(s)  
ALTA VISTA

| Est. Time | Stop Description                             | Notes | Load | Dist |
|-----------|--|-------|------|------|
| 07:18AM   | BAHIA VISTA ST & OAK VIEW DR/E BOUND         |       | 4    | 2.7  |
| 07:26AM   | BENEVA RD & PARAKEET WY/N BOUND              |       | 6    | 1.8  |
| 07:43AM   | 21ST ST & MAPLE AVE/KG ONLY                  |       | 20   | 5.1  |
| 07:46AM   | GILLESPIE AVE & 19TH ST                      |       | 16   | 0.7  |
| 08:05AM   | ALTA VISTA ELEMENTARY, 5 ALTA VISTA BUS LOOP |       | 48   | 3.2  |

Date Printed: 4/6/2018  
Time Printed: 8:41:42AM

**Vehicle Schedule 2017-2018**  
**Summary Report Bus: 1328**  
ALTA VISTA

Name: 1328 RT 3-A012/17TH  
Driver: TAMEKA WINDER  
Attendent:

School(s)  
ALTA VISTA

| Est Time | Stop Description   | Notes | Load | Dist |
|----------|--|-------|------|------|
| 07:28AM  | OLD BRADENTON RD & 34TH ST/N BOUND                         |       | 1    | 2.0  |
| 07:31AM  | 4900 N TAMiami TrL/N BOUND (SHL) AIRPORT MOTEL             |       | 0    | 1.4  |
| 07:33AM  | UNIVERSITY PKWY & DESOTO PL/E<br>BOUND/SHL-201-291-181-171 |       | 3    | 0.4  |
| 07:42AM  | 21ST ST & MAPLE AVE/1ST, & 2ND GRADE ONLY                  |       | 38   | 3.5  |
| 08:00AM  | ALTA VISTA ELEMENTARY, 5 ALTA VISTA BUS LOOP               |       | 42   | 3.6  |

Date Printed: 4/3/2018  
Time Printed: 9:14:34AM

**Vehicle Schedule 2017-2018**  
**Summary Report Bus: 1202**  
ALTA VISTA

Name: 1202 RT 4-A012/17TH  
Driver: CHRISTINE WALKER  
Attendent:

School(s)  
ALTA VISTA

| Est.Time | Stop Description                             | Notes | Load | Dist |
|----------|--|-------|------|------|
| 07:40AM  | DIXIE AVE & 24TH ST                          |       | 22   | 1.6  |
| 07:46AM  | BLVD OF THE ARTS & COHEN WAY                 |       | 12   | 1.9  |
| 08:05AM  | ALTA VISTA ELEMENTARY, 5 ALTA VISTA BUS LOOP |       | 34   | 2.7  |

# Alta Vista

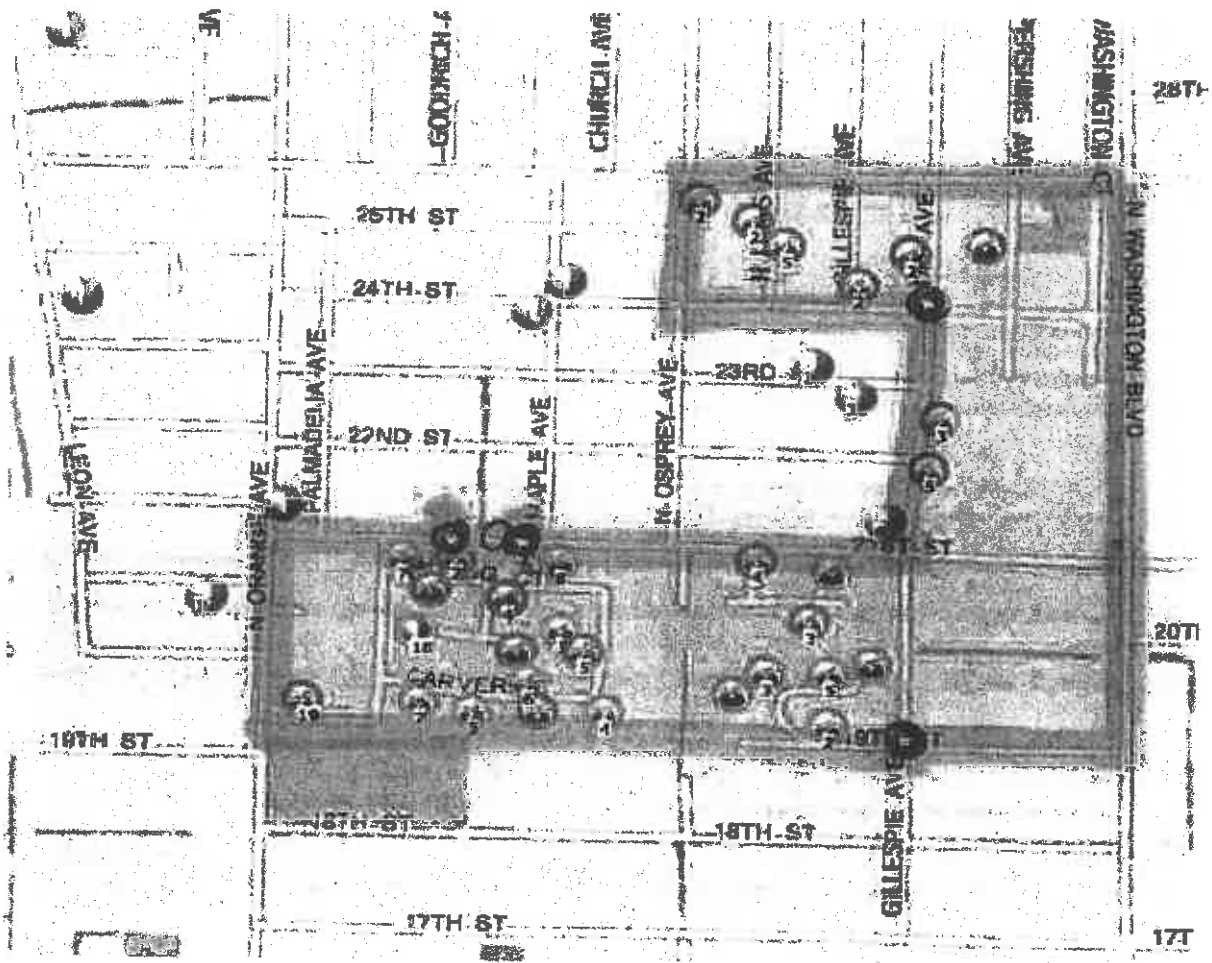

Date Printed: 4/3/2018  
Time Printed: 9:20:53AM

**Vehicle Schedule 2017-2018**  
**Summary Report Bus: 1418**  
**BRENTWOOD ELEMENTARY**

Page 1 of 2

Name: 1418 RT 1-A101/OSP  
Driver: JEFF RUTHERFORD  
Attendent:

School(s)  
BRENTWOOD ELEMENTARY

| Est Time | Stop Description                                | Notes | Load | Dist |
|----------|---|-------|------|------|
| 07:27AM  | DESOTO RD & CONSERVATORY DR/C BEACHY/M,W,F ONLY |       |      | 5.7  |
| 07:36AM  | N ORANGE AVE & 29TH ST                          |       | 19   | 4.3  |
| 07:42AM  | 29TH ST & GILLESPIE AVE                         |       | 11   | 0.5  |
| 07:48AM  | MAPLE AVE & 24TH ST                             |       | 15   | 0.3  |
| 08:12AM  | BRENTWOOD ELEMENTARY, 2500 VINSON AVE #16       |       | 45   | 6.8  |



Date Printed: 4/3/2018  
Time Printed: 9:30:15AM

# Vehicle Schedule 2017-2018

## Summary Report Bus: 1201 FRUITVILLE ELEMENTARY

Name: 1201 RT 3-A131/17TH  
Driver: THOMAS DOCTER  
Attendent:

School(s)  
FRUITVILLE ELEMENTARY

| Est.Time | Stop Description                          | Notes | Load | Dlat |
|----------|---|-------|------|------|
| 07:37AM  | CENTRAL AVE & VALERIE LN                  |       | 29   | 3.4  |
| 08:00AM  | FRUITVILLE ELEMENTARY, 601 HONORE AVE #16 |       | 29   | 6.9  |

Frattville E1

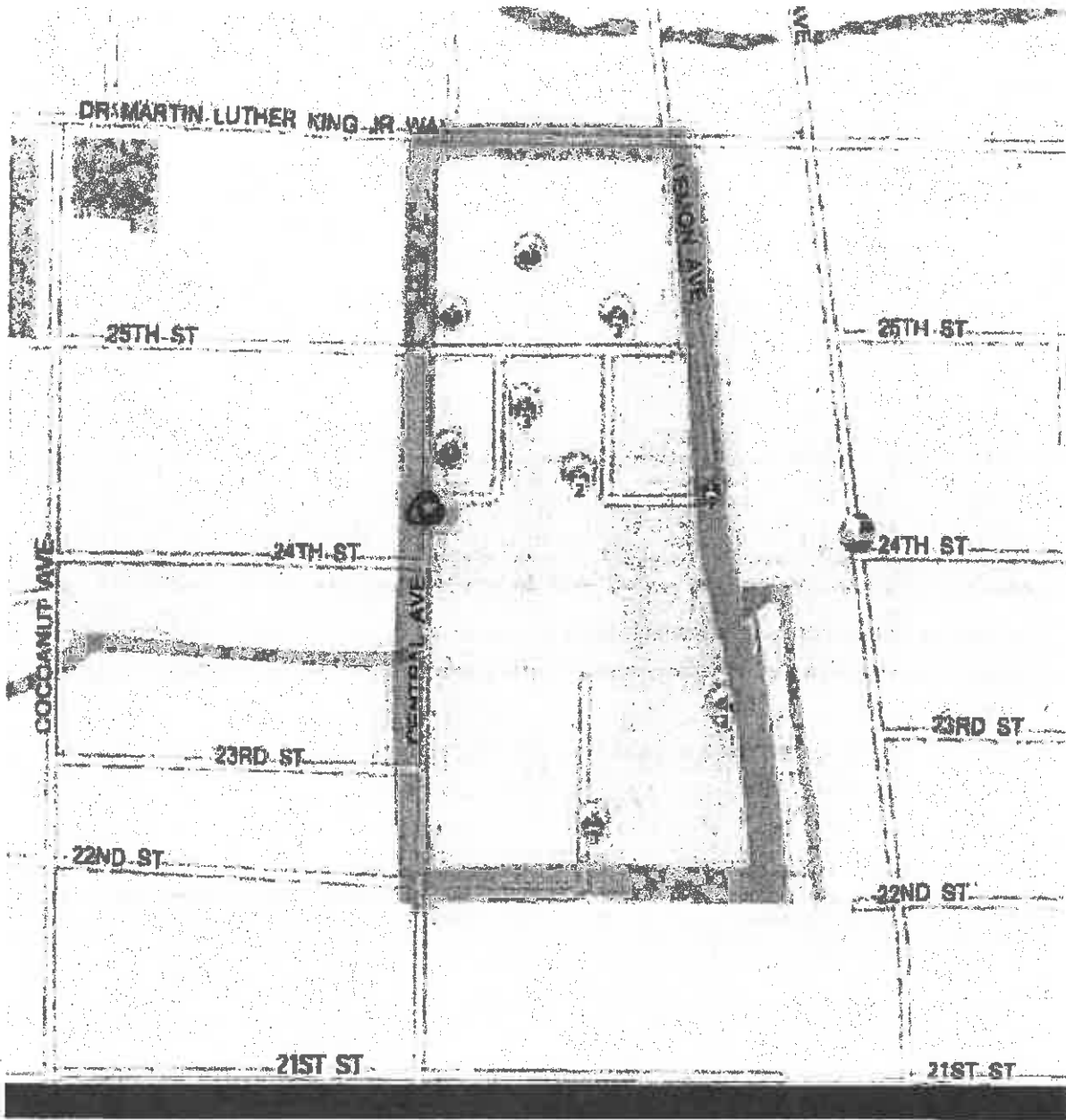



Date Printed: 4/3/2018  
Time Printed: 9:46:24AM

**Vehicle Schedule 2017-2018**  
**Summary Report Bus: 1318**  
GOCIO ELEMENTARY

Name: 1318 RT 2-A261/17TH  
Driver: SAMAN SISTANI  
Attendent:

School(s)  
GOCIO ELEMENTARY

| Est.Time | Stop Description                | Notes | Load | Dist |
|----------|---------------------------------|-------|------|------|
| 07:49AM  | CENTRAL AVE & 16TH ST           |       | 11   | 1.1  |
| 07:51AM  | CENTRAL AVE & 20TH ST           |       | 28   | 0.4  |
| 08:00AM  | GOCIO ELEMENTARY, 3450 GOCIO RD |       | 39   | 3.3  |

Date Printed: 4/3/2018  
Time Printed: 9:47:09AM

# Vehicle Schedule 2017-2018

Summary Report Bus: 1212  
GOCIO ELEMENTARY

Name: 1212 RT 3-A261/17TH  
Driver: PETER BUSSIERE  
Attendent:

School(s)  
GOCIO ELEMENTARY

| Est.Time | Stop Description                     | Notes | Load | Dist |
|----------|--------------------------------------|-------|------|------|
| 07:39AM  | N TAMiami TRL & 23RD ST/S BOUND      |       | 6    | 2.7  |
| 07:42AM  | COCOANUT AVE & 12TH ST               |       | 14   | 1.0  |
| 07:45AM  | COCOANUT AVE & 22ND ST               |       | 16   | 0.5  |
| 07:49AM  | 18TH ST & GILLESPIE AVE/off U.S. 301 |       | 3    | 1.1  |
| 08:10AM  | GOCIO ELEMENTARY, 3450 GOCIO RD      |       | 39   | 3.5  |

Date Printed: 4/6/2018  
Time Printed: 10:36:18AM

**Vehicle Schedule 2017-2018**  
**Summary Report Bus: 1714**  
**GOCIO ELEMENTARY**

Page 1 of 1

Name: 1714 RT 4-A261/17TH  
Driver: JOEL DAHL  
Attendent:

School(s)  
GOCIO ELEMENTARY

| Est. Time | Stop Description                                | Notes | Load | Dist |
|-----------|---|-------|------|------|
| 07:40AM   | N ORANGE AVE @ ORANGE TRAILOR PARK/N OF 12TH ST |       | 65   | 2.5  |
| 07:43AM   | MARTIN L KING JR WY & MANGO AVE/0261- 181 SHL   |       | 0    | 1.8  |
| 08:00AM   | GOCIO ELEMENTARY, 3450 GOCIO RD                 |       | 65   | 2.1  |

Gocio E1

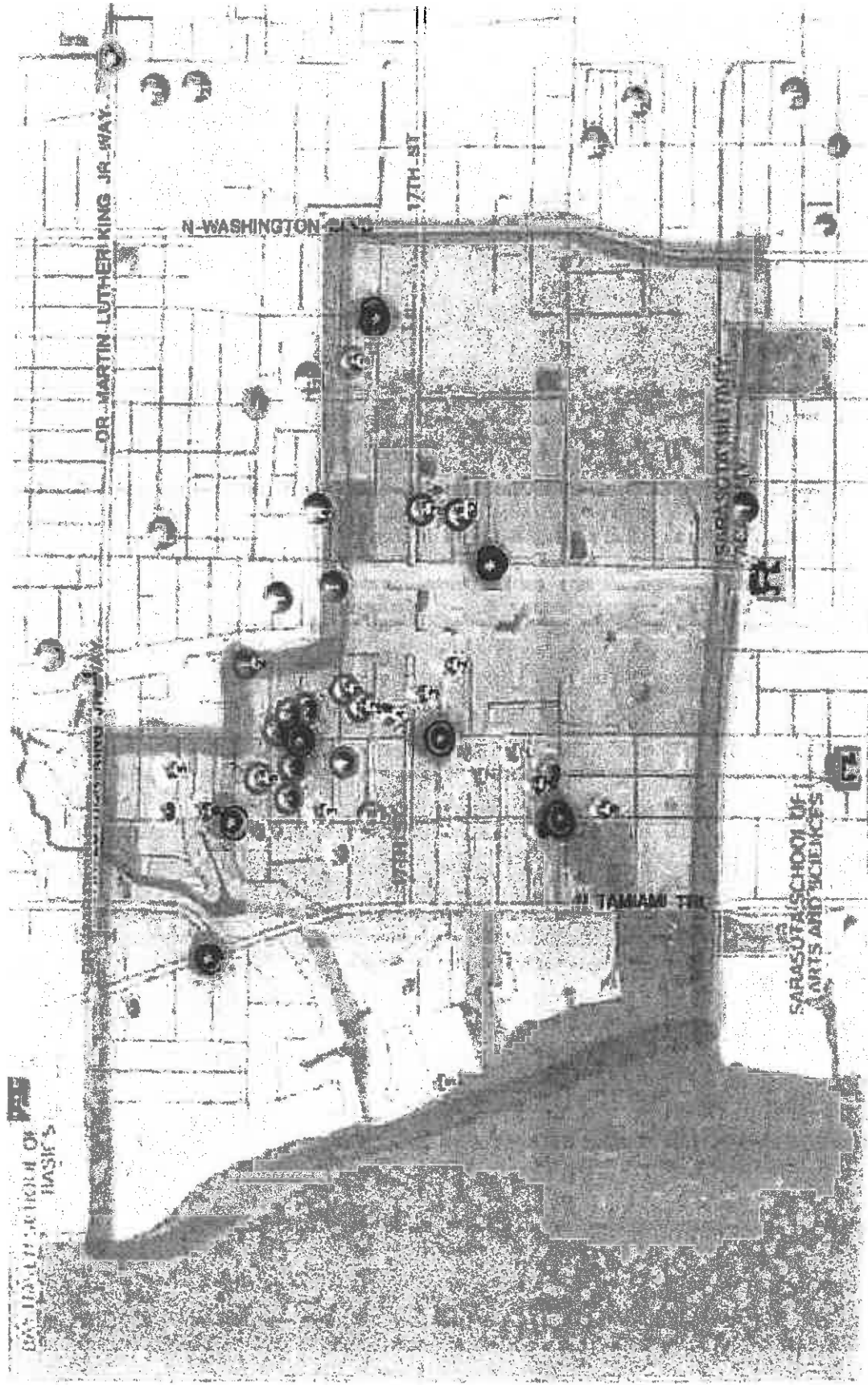

Date Printed: 4/3/2018  
Time Printed: 10:00:49AM

# Vehicle Schedule 2017-2018

## Summary Report Bus: 1411 PHILLIPPI SHORES ELEMENTARY

Name: 1411 RT 1-A171/OSP  
Driver: DAVID KNICKERBOCKER  
Attendent:

School(s)  
PHILLIPPI SHORES ELEMENTARY

| Est Time | Stop Description                                   | Notes | Load | Dist |
|----------|--|-------|------|------|
| 07:29AM  | 1765 29TH ST /PICK UP/DROP OFF "GUILDA" ONLY       |       | 0    | 1.5  |
| 07:32AM  | OLD BRADENTON RD & HIGHLAND ST/N BOUND             |       | 9    | 1.1  |
| 07:34AM  | MYRTLE ST & CENTRAL AVE/E BOUND                    |       | 14   | 0.4  |
| 07:40AM  | 31ST ST & DIXIE AVE                                |       | 17   | 0.9  |
| 08:05AM  | PHILLIPPI SHORES ELEMENTARY, 4747 S TAMIAMI TRL #3 |       | 40   | 6.9  |

Date Printed: 4/3/2018  
Time Printed: 10:01:52AM

# Vehicle Schedule 2017-2018

## Summary Report Bus: 1217 PHILLIPPI SHORES ELEMENTARY

Name: 1217 RT 2-A171/17TH  
Driver: DONALD ZEHR  
Attendent:

School(s)  
PHILLIPPI SHORES ELEMENTARY

| Est. Time | Stop Description  | Notes | Load | Dist |
|-----------|---|-------|------|------|
| 07:30AM   | N ORANGE AVE@BOOKER HIGH PARKING ENT/S BOUND/JIM<br>A. ONLY |       | 0    | 7.3  |
| 07:33AM   | N ORANGE AVE & 29TH ST                                      |       | 13   | 0.2  |
| 07:36AM   | 29TH ST & MAPLE AVE   |       | 17   | 0.1  |
| 07:38AM   | 29TH ST & N LINKS AVE                                       |       | 10   | 0.4  |
| 08:05AM   | PHILLIPPI SHORES ELEMENTARY, 4747 S TAMiami TRL #3          |       | 40   | 5.8  |

Phillippi Shores

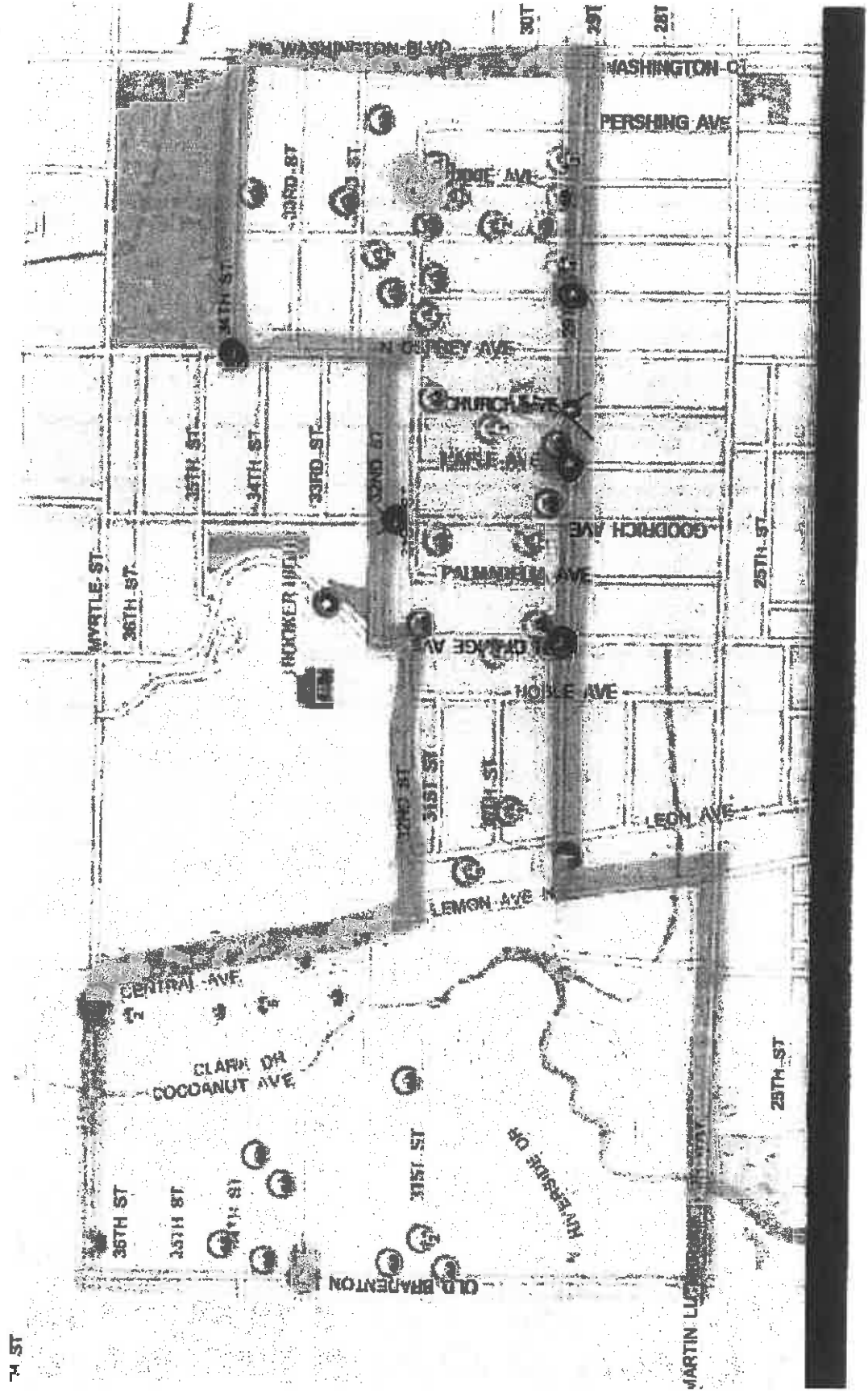

74 ST

Date Printed: 4/3/2018  
Time Printed: 10:05:11AM

**Vehicle Schedule 2017-2018**  
**Summary Report Bus: 1323**  
**SOUTHSIDE ELEMENTARY**

Page 1 of 2

Name: 1323 RT 2-A191/17TH  
Driver: GERMANIA PAREDES  
Attendent:

School(s)  
SOUTHSIDE ELEMENTARY

| Est.Time | Stop Description   | Notes | Load | Dist |
|----------|--|-------|------|------|
| 07:30AM  | BLVD OF THE ARTS & COHEN WY                                  |       | 1    | 2.1  |
| 07:38AM  | E ROYAL FLAMINGO DR & WOOD DUCK DR                           |       | 5    | 2.6  |
| 07:52AM  | JOHN RINGLING CSWY & N GULF STREAM AVE/ 50FT<br>BEFORE LIGHT |       | 2    | 1.8  |
| 07:59AM  | TUTTLE TERR & JUNIPER PL                                     |       | 43   | 3.8  |
| 08:05AM  | SOUTHSIDE ELEMENTARY, 1901 WEBBER ST #1                      |       | 51   | 1.5  |



Southside E1

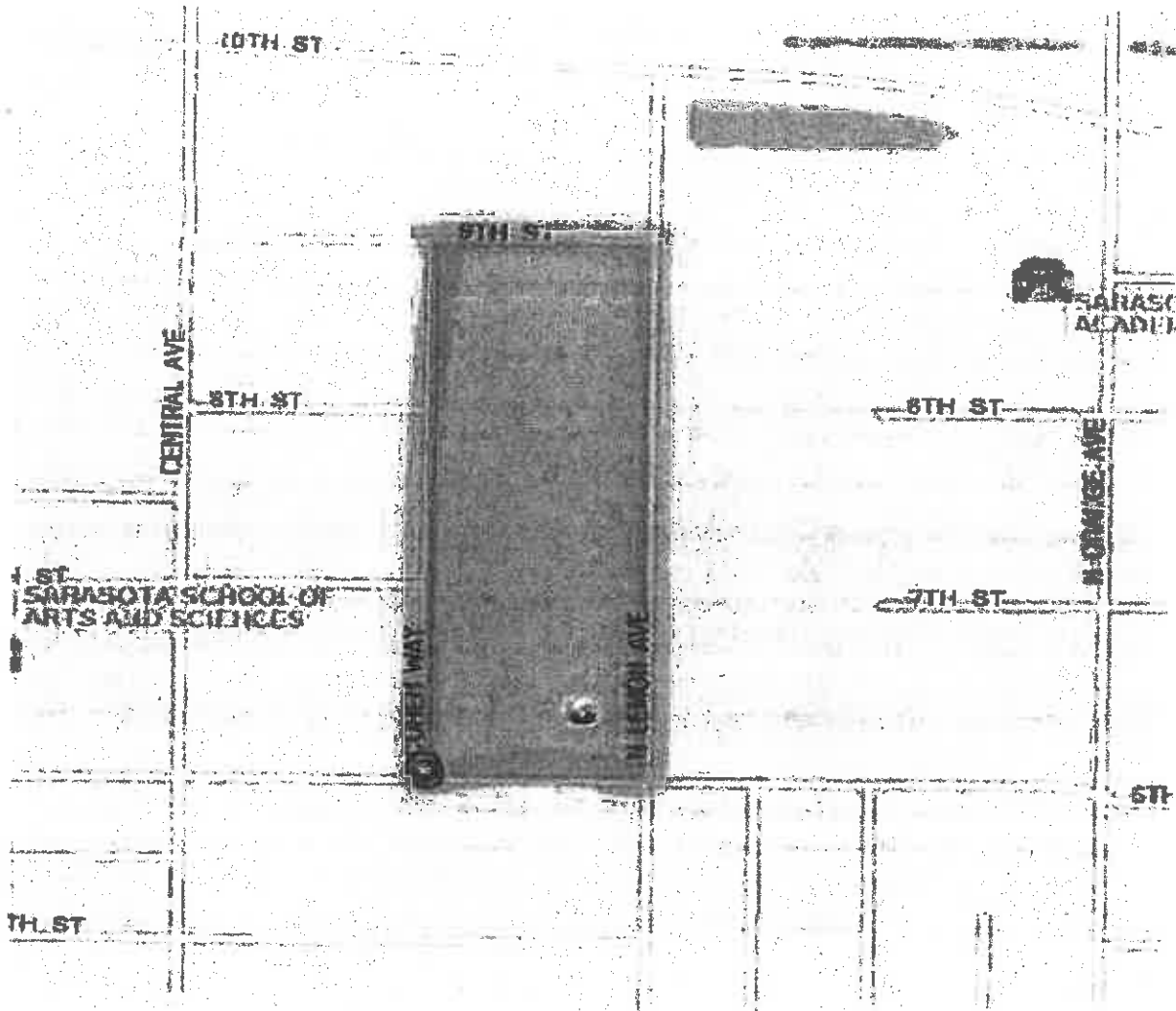

Date Printed: 4/3/2018  
Time Printed: 10:09:22AM

# Vehicle Schedule 2017-2018

## Summary Report Bus: 1209 TUTTLE ELEMENTARY

Name: 1209 RT 1-A201/17TH  
Driver: CAROL SWAIN  
Attendent:

School(s)  
TUTTLE ELEMENTARY

| Est. Time | Stop Description  | Notes | Load | Dist |
|-----------|---|-------|------|------|
| 07:33AM   | BRADENTON RD & 39TH ST@ SCAT/N BOUND                          |       | 10   | 2.0  |
| 07:36AM   | OLD BRADENTON RD & 46TH ST/N BOUND                            |       | 7    | 0.3  |
| 07:41AM   | N WASHINGTON BLVD & SANFORD CIR/S BOUND/50 FT<br>BEFORE LIGHT |       | 6    | 1.9  |
| 07:43AM   | MYRTLE ST & BUTLER AVE/SHL-141                                |       | 20   | 0.6  |
| 07:46AM   | GOODRICH AVE & 35TH ST  |       | 17   | 0.3  |
| 08:00AM   | TUTTLE ELEMENTARY, 2863 8TH ST #5                             |       | 60   | 2.9  |

Tuttle EL

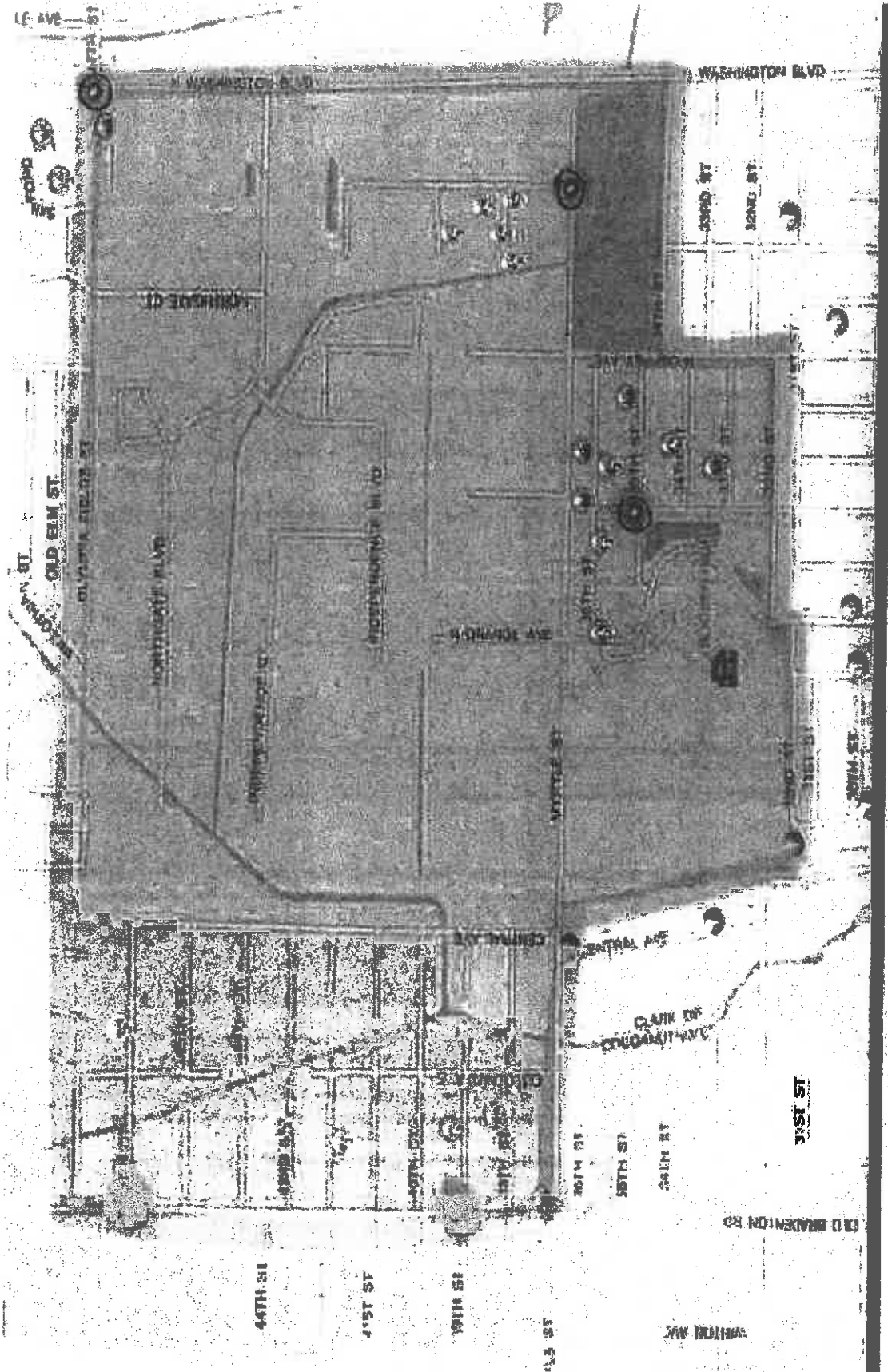

Date Printed: 4/3/2018  
Time Printed: 10:24:02AM

# Vehicle Schedule 2017-2018

## Summary Report Bus: 1311 WILKINSON ELEMENTARY

Name: 1311 RT 1-A291/17TH  
Driver: SHAWN PANNACCIULLI  
Attendent:

School(s)  
WILKINSON ELEMENTARY

| Est Time | Stop Description                           | Notes | Load | Dist |
|----------|--|-------|------|------|
| 07:29AM  | DR MARTIN LUTHER KING JR WY & MANGO AVE    |       | 1    | 1.8  |
| 07:32AM  | N ORANGE AVE & 24TH ST                     |       | 17   | 1.1  |
| 07:35AM  | N ORANGE AVE & 20TH ST                     |       | 18   | 0.2  |
| 08:00AM  | WILKINSON ELEMENTARY, 3400 WILKINSON RD #1 |       | 36   | 6.8  |

Date Printed: 4/3/2018  
Time Printed: 10:25:35AM

**Vehicle Schedule 2017-2018**  
**Summary Report Bus: 1320**  
WILKINSON ELEMENTARY

Name: 1320 RT 2-A291/17TH  
Driver: THOMAS MARKHAM  
Attendant:

School(s)  
WILKINSON ELEMENTARY

| Est. Time | Stop Description  | Notes | Load | Dist |
|-----------|---|-------|------|------|
| 07:15AM   | ALTA VISTA BUS LOOP/PU TRANSFER<br>ATTENDANT-J. WILLIAMS FROM BUS #1414 |       | 0    | 0.9  |
| 07:37AM   | DIXIE AVE & 23RD ST   |       | 14   | 3.1  |
| 07:40AM   | 22ND ST & N OSPREY AVE  |       | 12   | 0.2  |
| 08:00AM   | WILKINSON ELEMENTARY, 3400 WILKINSON RD #1                              |       | 26   | 6.7  |

Wilkinson E1

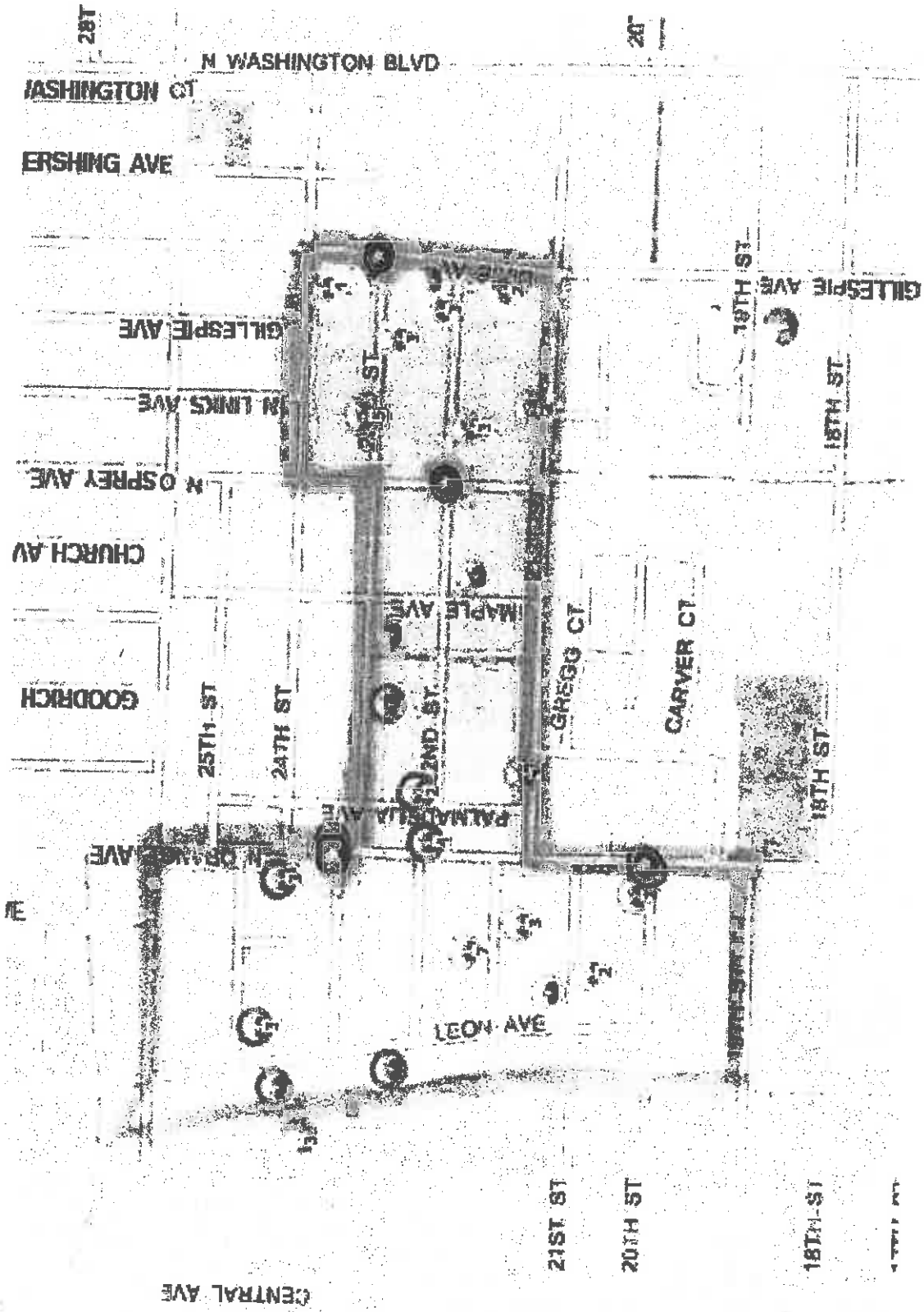

**TAB**

**3**

*Final Order*

IN THE UNITED STATES DISTRICT COURT FOR THE MIDDLE DISTRICT  
OF FLORIDA TAMPA DIVISION

|   |   |                  |
|---|---|------------------|
| MAXINE MAYS, et al.,                                      | * |                  |
|   | * |                  |
| Plaintiffs,   | * |                  |
|   | * |                  |
| vs.   | * | No. 4242 Civ. T. |
|   | * |                  |
| SARASOTA COUNTY BOARD<br>OF PUBLIC INSTRUCTION,<br>et al, | * |                  |
|   | * |                  |
| Defendants  | * |                  |

FINAL ORDER

THIS CAUSE came before the Court upon consideration of the file. This case is an illuminating one in the area of school desegregation. The defendant Sarasota County Board of Public Instruction has consistently made efforts to comply with decisions of the Supreme Court of the United States and with orders of this court. A unitary school system has been in effect in Sarasota County at least since September, 1970. The Court previously indicated that it would consider a motion to end its jurisdiction and to dismiss this case by order entered June 29, 1970. Such a motion was filed on December 4, 1970, but the Court denied the motion in order that the plan adopted by the defendant school board could be evaluated in practice. By order entered August 23, 1971, the Court directed the parties to submit memoranda relative to whether or not this action should be dismissed.

The plaintiffs responded to the Court's order, agreeing to a dismissal of this action. The efforts of the defendants during the pendency of this action have been commendable. Plaintiffs' response to the August 23, 1971, order places proper prospective upon defendants' handling of this case:

"Defendant Board has met its constitutional duty to disestablish its former dual school system in a prompt, honorable and responsible fashion that might well serve as a model for other boards seeking to comply with federal court mandates."



The Court agrees with this conclusion. Vestiges of state imposed segregation have been removed from the operation of the public school system in Sarasota County. There is no evidence counter- ing the conclusion that the unitary school system now established in Sarasota County has stabilized.

Difficulties encountered by other school systems in establish- ing a unitary system of public education might well have been avoided if the cooperative and responsible attitude displayed by the defendants in this action had been adopted. The Court agrees with plaintiffs and defendants that this action should be dismissed. Swann v. Charlotte-Mecklenburg Board of Education, 91 S.Ct.1267(1971); Green v. County School Board of New Kent County, 391 U.S.430 (1968).

The Court commends the actions and attitudes of all parties to this action and their respective counsel. Whereupon, it is

ORDERED and ADJUDGED;

Upon the Court's own motion and upon agreement of the parties, this action is hereby dismissed.

DONE and ORDERED at Tampa, Florida, this 3rd day of September, 1971.

*Ben Kregozian*  
\_\_\_\_\_  
BEN KREGOZIAN  
UNITED STATES DISTRICT JUDGE



a prompt, honorable and responsible fashion that  
might well serve as a model for other boards  
seeking to comply with federal court mandates.

WHEREFORE, for the foregoing reasons, Plaintiffs  
respectfully agree to the dismissal of this school desegregation  
case by September 20, 1971.

Respectfully submitted,

~~Jack Greenberg~~  
Jack Greenberg  
Norman J. Chachkin  
Drew S. Days III  
10 Columbus Circle  
New York, New York 10019

James B. Sanderlin  
1407 22nd Street, South  
St. Petersburg, Florida 33712

Attorneys for Plaintiffs

IN THE UNITED STATES DISTRICT COURT FOR THE MIDDLE DISTRICT OF  
FLORIDA TAMPA DIVISION

MAXINE MAYS, ET AL., )

Plaintiffs, )

vs. )

No. 4242 Civ. T. )

SARASOTA COUNTY BOARD OF  
PUBLIC INSTRUCTION, ET AL., )

Defendants )

MOTION TO DISMISS

Defendants move the Court to dismiss this action on the ground that Plaintiffs have shown no right to further relief for the reasons set forth herein:

1. The Orders of this Court of April 7, 1967 and January 29, 1970 respecting a desegregation plan for Sarasota County's public schools have been complied with since February 6, 1970, and the Board's certificate of compliance has been filed with the Court.

2. The Defendant Board of Public Instruction of Sarasota County filed its Amended Plan of Desegregation May 27, 1970 and after a hearing held June 29, 1970 the Court entered its Order approving the Amended Desegregation Plan with regard to the Booker-Bay Haven project and the Osprey Elementary School; this Order of the Court has been complied with and in all other respects the Defendant School Board has been in continual compliance with Orders of this Court. Statistical summaries are appended which show the present numbers of white and black students and faculty in each school.

3. The Court has retained jurisdiction for a reasonable time (since February 6, 1970) after the Defendant's school system became a unitary one to insure that the system is operated

in a constitutional manner and that it is clear that the state imposed segregation has been completely removed.

4. This Motion is made pursuant to the provisions of the Court's Order of June 29, 1970.

*Richard W. Cooney*

Richard W. Cooney  
Attorney for Defendants  
10 South Adams Drive  
P.O. Box 6167  
Sarasota, Florida 33578

CERTIFICATE OF SERVICE

I hereby Certify that copies of the foregoing Motion to Dismiss have been mailed this 3 day of December, 1970 to JAMES B. SANDERLIN, 1407 22nd Street, St. Petersburg, Florida 33712, I. W. WILLIAMS, P.O. Box 13517, St. Petersburg, Florida 33733, and JACK GREENBERG, 10 Columbus Circle, Suite 2030, New York, New York 10019, by United States Mail.

*Richard W. Cooney*

Richard W. Cooney